

SATCOM COMPONENT

DC Power_M&C Cable Assembly for BUC



TYPICAL SPECIFICATIONS

Electrical Specifications

J1 (12pin)	DC, Ethernet, RS232, External mute
J2 (2pin)	+24VDC ±10% +36 ~ +72 VDC
J3 (3pin)	RS232
J4 (4pin)	Ethernet
J5 (3pin)	External mute

Applications

- Used to monitor and control the BUC via RS232 or Ethernet communication, and the external mute.
- Used to connect BUC to DC power supply
- Can be used at the outdoors because J1 and J2 connectors are water-proof

Mechanical Specifications

J1 (12pin)	MS3116A 14S-12S, female
J2 (2pin)	MS3106A 14S-9S, female
J3 (3pin)	DS-09S, female
J4 (4pin)	RJ-45, male
J5 (3pin)	open wires
Length between J1 and J2	> 1m (depending on request)
Weight	< 500g (for 3m cable)
Color	Black

Environmental Specifications

Operating temperature -50 to +100 ℃

HOW TO ORDER DC POWER_M&C CABLE ASSY

CA-RE-48-1

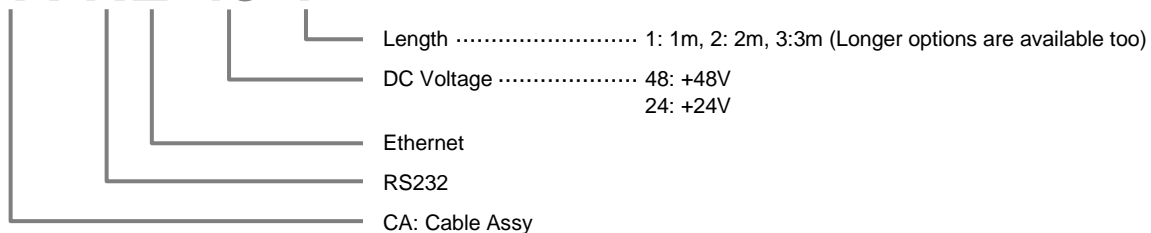

SATCOM COMPONENT

CABLING CONFIGURATION

Configuration of BUC + Power Supply + Cable Assembly

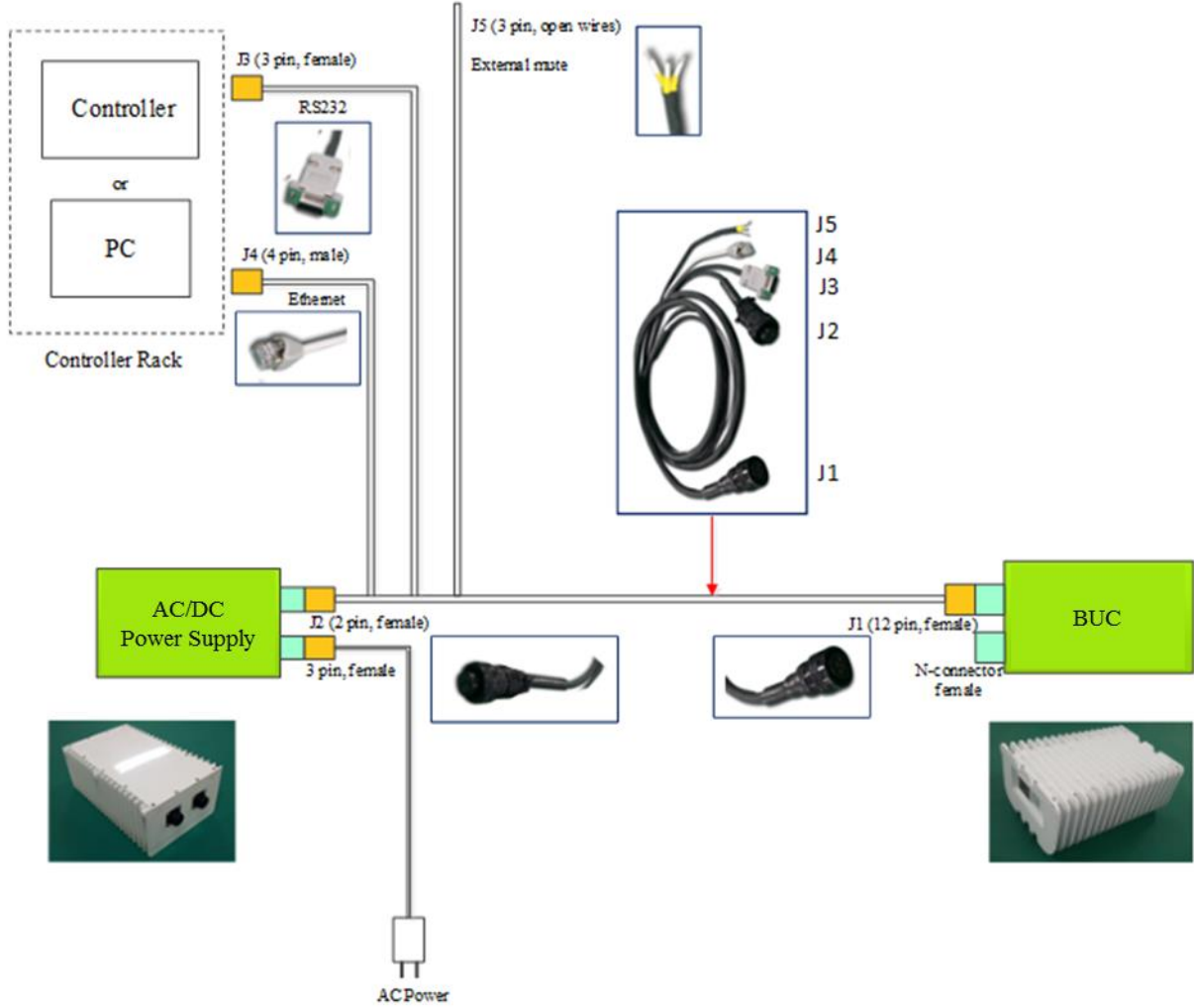

Pin map of DC power_M&C cable connector

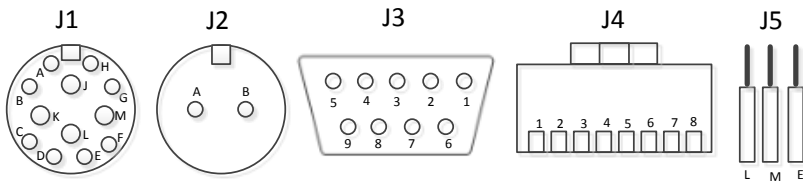

[Front view]

Description	J1 Pin No.	J2 Pin No.	J3 Pin No.	J4 Pin No.	J5 Pin No.
Ethernet Tx-	A	-	-	1	-
Ethernet Tx+	B	-	-	2	-
Ethernet Rx+	C	-	-	3	-
Ethernet Rx-	D	-	-	6	-
-	E	-	-	-	E
RS-232 GND	F	-	5	-	-
RS-232 TxD	G	-	2	-	-
RS-232 RxD	H	-	3	-	-
DC Power+	J	A	-	-	-
DC Power return	K	B	-	-	-
Ext. Mute (High)	L	-	-	-	L*
Ext. Mute GND	M	-	-	-	M*

* When J5-L and J5-M connected, external mute is inactivated .
When J5-L and J5-M disconnected, external mute is activated.